

Level 2 EV Charging Station

Phase Mode: Single Phase
Installation Method: Wall/Stand
Mode: Universal Socket
Certificate: CE, TUV, RCM
IP Rating: IP66
Rated Voltage: 230VAC+/-10%
Rated Current: 32A
Maximum Power: 7.4 kW
Ambient External Temp: -25°C ~ +55°C
Enclosure Material: ABS+PC alloy
Start Mode: Button (default)

Phase Mode: Three Phase
Installation Method: Wall/Stand
Mode: Universal Socket
Certificate: CE, TUV, RCM
IP Rating: IP66
Rated Voltage: 380VAC+/-10%
Rated Current: 32A
Maximum Power: 22 kW
Ambient External Temp: -25°C ~ +55°C
Enclosure Material: ABS+PC alloy
Start Mode: Button (default)

Instruction for Use

①

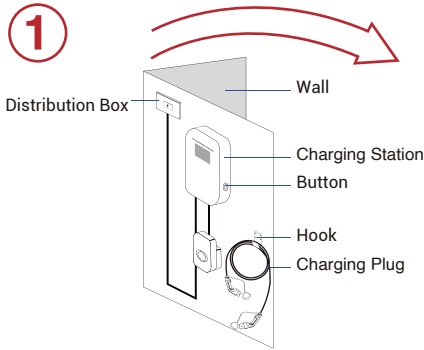

Make sure the walbox is connected to power

②

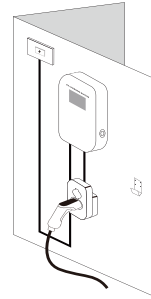

Insert the plug into socket

③

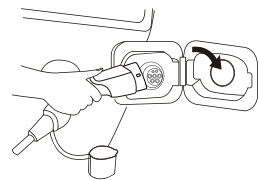

Connect the EV and the wallbox with the EV charging cable

◆ Hang the cable on the hook when it is not in use



MANUFACTURER
Ocular Charging

ocularcharging.com.au
sales@ocularcharging.com.au